

# "CMB" MODEL WITH DUAL SHAFT

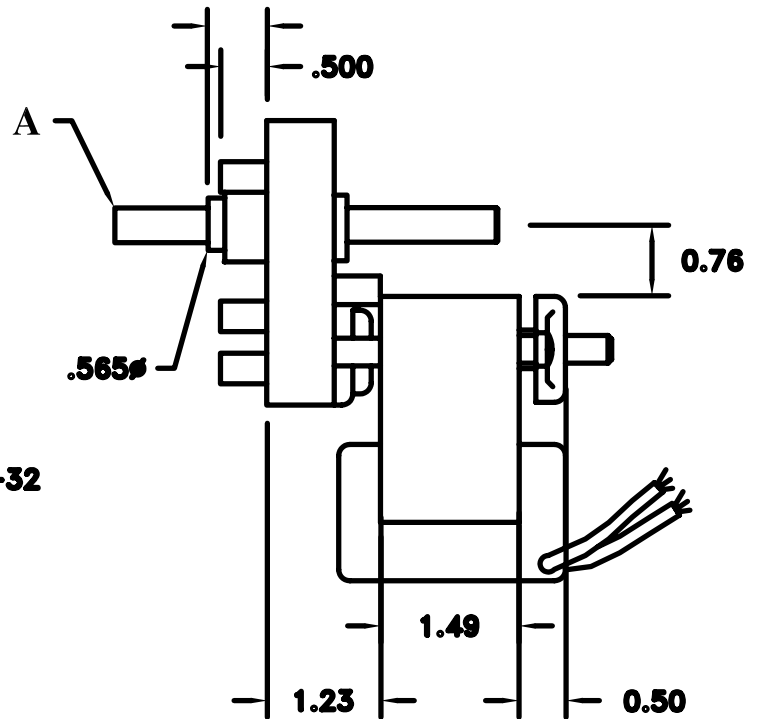
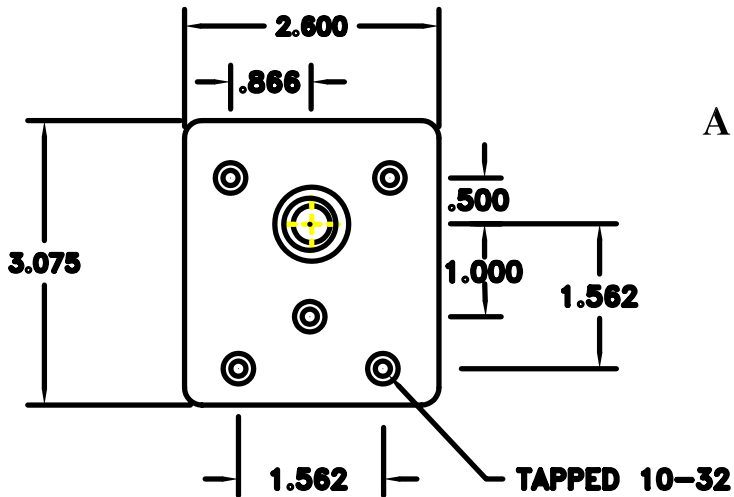

## AC UNIDIRECTIONAL GEARMOTOR

- A - OUTPUT SHAFT DIAMETER & LENGTH  
PER CUSTOMER REQUIREMENTS.
- B - FROM 5/8" TO 2" DEPENDING UPON  
R.P.M. AND LOAD REQUIREMENTS.

- \* OUTPUT SPEED FROM 2 - 500 RPM
- \* OUTPUT TORQUE TO 50 IN. LB.
- \* 24/120/240 VAC/ 50/60 HZ
- \* CONTINUOUS OR INTERMITTANT DUTY
- \* SELF-RESETTING THERMAL PROTECTION
- \* U.L., C.S.A. & T.U.V. APPROVED
- \* 18 GAUGE LEADS

## OPTIONS:

- HIGH TEMPERATURE PLASTIC FAN,  
2 1/2"  $\phi$  x 3/4" THICK
- HEAVY DUTY NEEDLE BEARINGS
- FRICTION BRAKES
- TERMINALS
- ONE WAY CLUTCH

REX ENGINEERING CORP.

TITUSVILLE, FL (321)268-5500